



GAUR

SUITES
FOR THE CHOSEN FEW

COMMERCIAL STUDIO APARTMENTS

**TAKING YOUR
LIFESTYLE TO NEW HEIGHTS**

THE WORLD HAS CHECKED-IN AT NOIDA

The who's who of the business world are all at NOIDA now



NOIDA INTERNATIONAL AIRPORT
India's Largest Airport being built with an investment of ₹ 29,500 CRORES approx by Zurich Airport International AG



FILM CITY
India's Largest Film City project developing over an area of 1000 acres



VIVO, a leading mobile manufacturer has taken 169 acres of land and will invest ₹ 3500 CRORES creating 25,000 JOBS



India's Biggest **SMARTPHONE MANUFACTURING HUB.**



India's Fourth Largest **IT-BPO DESTINATION.**

NOIDA IS BOOMING WITH MORE **MNCs, START UPS & PSUs**

THE BIGGEST **PAYTM CAMPUS** SPREAD ACROSS 10 ACRES TO PROVIDE **15000 JOBS**

PATANJALI'S ₹ 6,000-CRORES FOOD PARK COMING UP IN 455 ACRES.

WORLD TRADE CENTRE IS INVESTING **21 BILLION DOLLARS** SPREAD ACROSS 42 ACRES

WORLD'S LARGEST MOBILE FACTORY SET UP BY **SAMSUNG** IN NOIDA

INFOSYS, INDIA'S SECOND LARGEST SOFTWARE FIRM TO INVEST **₹ 750 CRORES** IN THE FIRST PHASE

INDIA'S FIRST CITY TO HAVE A **MOBILE OPEN EXCHANGE (MOX)**



Toy City



Electric Vehicle Hub



Handicraft Park



Leather Manufacturing Park and many more



Furniture Park



Logistics Hub



Data Centre Park



Textile City



Food Park



Heritage Corridor



Metro Coach Manufacturing

THE THRUST BEHIND PROGRESS

The wind beneath NOIDA's wings



YEIDA stands for Yamuna Expressway Industrial Development Authority

and today has the largest industrial landbank in the country which would see rapid development. The initial budget set for YEIDA was ₹ 12,500 crore approximately.

With an area of 2,689 sq km under its belt, it is the biggest industrial township project that covers connectivity, industrial development, and infrastructure development.

YEIDA also promises to develop smart villages along the 165 km stretch. It is one of the driving forces behind Noida's growth and development.

YEIDA's master plan of 2031 predicts rapid and extensive real estate development.

Yamuna Expressway is the **MOST MODERN INFRASTRUCTURE** development that connects Delhi/Noida/Gr. Noida with Western UP/Agra and Lucknow.

It's a 165 km long 6-lane Expressway surrounded by **1,187 VILLAGES** comprising of **6 DISTRICTS**

The traveling time between **AGRA & DELHI** that stretches 211 km has come down to approx. 150 minutes & just 90 minutes from Greater Noida.

The U.P. government has declared Yamuna Expressway belt as an **ELECTRONICS MANUFACTURING ZONE**

The U.P. government has appointed Yamuna Expressway as the nodal agency of the project and YEIDA has already identified **5,000 HECTARES** for this purpose.

NOIDA IS CRUISING WITH EASE & ACCESSIBILITY

Strategic location and seamless connectivity - an unbeatable winning combination for NOIDA



AIRPORT'S EFFECT ON THE REGION.

- Jewar is likely to serve as a major logistics and travel hub for various manufacturing and export centers as soon as the airport becomes operational.
- Like other major infrastructure projects that benefit real estate markets, the Noida International Airport, too, will change the property market dynamics in Noida and the adjoining areas making Noida International Airport the biggest job creator. Dainik Jagran - 8th October 2020



EASTERN PERIPHERAL EXPRESSWAY.

- A 135 km long, six-lane expressway intersects and passes through Yamuna Expressway.
- Eastern Peripheral Expressway is expected to divert more than 50,000 trucks away from Delhi and reduce air pollution in Delhi by 27%.
- It was inaugurated on 27 May 2018 by Prime Minister Narendra Modi.
- EPE to be connected with the airport. India Today - 28th May 2018



THE METRO LINK.

- A direct metro line to connect Jewar Airport with Delhi's Indira Gandhi International Airport.
- Greater Noida metro line will also intersect the proposed line. Indian Express - 21st October 2020



THE RAPID RAIL LINK.

- Rapid Rail Transit System (RRTS) will connect Sarai Kale Khan Bus transit and the airport. Amar Ujala - 2nd July 2022

WHY YAMUNA EXPRESSWAY-

Yamuna Expressway – For the discerning buyer

The Yamuna Expressway is a dream location for potential home buyers. It is one of the longest controlled-access expressways in India and directly connects Greater Noida to Agra which has enhanced the realty prospects of neighbouring regions as well. Ever since the Noida International Airport has been given the green light; it has experienced a major boom in value. It is giving way to progress, employment and supreme convenience. Eastern Peripheral Expressway that passes through Yamuna Expressway will benefit those travelling from Noida, Greater Noida and Gaur Yamuna City.

Yamuna Expressway is well connected to various amenities in the vicinity like hotels, schools, hospitals etc. Future developments on Yamuna Expressway include metro line expansion, construction of IT Hub, proposed monorail and ISBT etc. F1 Track at Buddh International Circuit is yet another attractive feature of Yamuna Expressway. The UP Government has declared Yamuna Expressway as an electronics manufacturing hub as well. To sum it all up, the Yamuna Expressway is where everything of essence is coming together to create the perfect framework for a harmonious life.



ACTUAL IMAGE



Hindustan Times 25th June 2022



The Times of India 26th April 2022

An investment in real estate in the Yamuna Expressway region which offers seamless connectivity, modern amenities and infrastructure and also booming industrial and commercial activity, is an investment towards a premium lifestyle and a future of limitless opportunities.

*All the information mentioned above has been taken from newspaper reports, websites and various news portals.



DESTINATION NEXT

The address of the future

Gaur Yamuna City (GYC) is an integrated township sprawling over a massive 101 hectares (250 acres). It is situated on the Yamuna Expressway, which is a 6 lane (extendable to 8 lanes), 165 km. long access-controlled highway connecting GYC to Noida, Greater Noida and Delhi. A well-planned highway with flyovers and interjections enabling clutter-free traffic. Proposed metro will further enhance its connectivity to the DMRC network.

Gaur Yamuna City offers Plots, Apartments, Retail Shops, Studio Apartments, Themed Villas, Sports facilities and a lot more.



HIGHLIGHTS

- AN INTEGRATED TOWNSHIP OF 101 HECTARE (250 ACRES) JUST 8-10 KMS*. FROM UPCOMING NOIDA INTERNATIONAL AIRPORT.
- BEAUTIFUL YAMUNA LAKE PARK WITH BOATING FACILITY.
- POSSESSION STARTED & FAMILIES HAVE MOVED IN THE GROUP HOUSING AND VILLA PROJECTS.
- OPERATIONAL GYC GALLERIA CONVENIENT SHOPPING CENTER.
- INDIA'S TALLEST STATUE OF LORD KRISHNA STANDING AT 108 FEET TALL ATOP A TEMPLE (UNDER CONSTRUCTION).
- OPERATIONAL GAURS INTERNATIONAL SCHOOL.
- MORE THAN 4 KM. ROAD INFRASTRUCTURE IN PLACE.
- RAIN WATER HARVESTING, SEWAGE TREATMENT PLANT AND SOLID WASTE MANAGEMENT SYSTEM.
- DEVELOPING SPECTACULAR CRICKET GROUND, TENNIS, BADMINTON, VOLLEYBALL, BASKETBALL, SKATING RINK, ATHLETIC TRACK & MORE WITHIN THE TOWNSHIP.
- DEVELOPING THE BIGGEST COMMERCIAL HUB OF YAMUNA EXPRESSWAY - AEROCITY YAMUNA - COMMERCIAL PLOTS WITH 100% GROUND COVERAGE AND UPTO 9 F.A.R. (FLOOR AREA RATIO)

EARMARKED FACILITY PLOTS (AS PER MASTER PLAN)

- PETROL PUMP
- CULTURAL CITY CENTRE
- MILK BOOTH & CONVENIENT SHOPS
- NURSING HOMES / DISPENSARY
- CRECHE & PLAY SCHOOL
- COMMERCIAL BUILDINGS



**WELCOME ON BOARD.
WE ARE ENROUTE TO
MODERN LIVING.**

Your gateway to a world of sophisticated living

LAUNCHING

**GUR
AERO
SUITES**
FOR THE CHOSEN FEW

**COMMERCIAL
STUDIO APARTMENTS**



Disclaimer: All images including stock images, colours, pictures and accessories are indicative and used for illustrative purposes only. For the actual project details, please refer to the specifications mentioned in the subsequent pages of this brochure.



ULTIMATE LOUNGE FOR LEISURE

Luxurious pampering for the leisure hours

Gaur Aero Suites is the ideal residential destination for today's jet setters. Built in contemporary style, it has retail shops on ground floor and the rest of the tower has efficient Commercial Studio Apartments.

It offers 1 BHK commercial studio apartments of 45.06 sq. mtr. (485 sq. ft.). An exclusive part of the most promising locations of Gaur Yamuna City, a massive 101 Hectares (250 acres) township advantageously situated on the 6 lane Yamuna Expressway.

With all the benefits of convenient location and the advantageous combination of commercial and retail sector, Gaur Aero Suites is the most sought after address of the uber rich.



ARTIST'S IMPRESSION

Disclaimer: All images including stock images, colours, pictures and accessories are indicative and used for illustrative purposes only. For the actual project details, please refer to the specifications mentioned in the subsequent pages of this brochure.



GAUR
AERO
SUITES
FOR THE CHOSEN FEW

**THE PLUSH FACE
OF CONTEMPORARY
LIVING TO TAKE YOU
ON A MEMORABLE
JOURNEY**

Revel in ultra-modern luxury

ARTIST'S IMPRESSION

WHEN IMMACULATE DESIGNS MEET WITH FINE CRAFTSMANSHIP, YOU ARE IN FOR A MEMORABLE EXPERIENCE.

Luxuriate in the exquisitely designed and finely crafted living spaces



Indicative Images of Sample Apartment.

METICULOUSLY DESIGNED TO MATCH THE MODERN YOU.

Actual Images of Sample Apartment.



CONTEMPORARY DESIGNS TO UNWIND THE URBAN YOU.



PROTEAN DESIGNS TO COMFORT THE ULTRA-MODERN YOU.



Disclaimer: All specifications, images including stock images, colours, pictures and accessories are indicative and used for illustrative purposes only. For the actual project details, please refer to the specifications mentioned in the subsequent pages of the brochure. *The apartment would be handed over in raw finish as per the specifications mentioned in the subsequent pages of the brochure. In case you need interiors to be done as per illustrations above, that can be done by us at an extra cost.

Disclaimer: All specifications, images including stock images, colours, pictures and accessories are indicative and used for illustrative purposes only. For the actual project details, please refer to the specifications mentioned in the subsequent pages of the brochure. *The apartment would be handed over in raw finish as per the specifications mentioned in the subsequent pages of the brochure. In case you need interiors to be done as per illustrations above, that can be done by us at an extra cost.

AMENITIES



ARTIST'S IMPRESSION

INFINITY POOL

For those who live the high life, we present to you our magnificent infinity pool that goes beyond the conventional.



GYM

Upgrade your lifestyle in every sphere.



PARTY HALL

Limitless fun comes to life every day.

Disclaimer: All specifications, images including stock images, colours, pictures and accessories are indicative and used for illustrative purposes only. For the actual project details, please refer to the specifications mentioned in the subsequent pages of the brochure. *The apartment would be handed over in raw finish as per the specifications mentioned in the subsequent pages of the brochure. In case you need interiors to be done as per illustrations above, that can be done by us at an extra cost.

Disclaimer: All specifications, images including stock images, colours, pictures and accessories are indicative and used for illustrative purposes only. For the actual project details, please refer to the specifications mentioned in the subsequent pages of the brochure. *The apartment would be handed over in raw finish as per the specifications mentioned in the subsequent pages of the brochure. In case you need interiors to be done as per illustrations above, that can be done by us at an extra cost.



G AUR YAMUNA CITY

YAMUNA EXPRESSWAY

MASTER PLAN

101.17 Hectares (250 Acres) Township

LEGEND

1. YAMUNA DWAR
2. SANGAM DWAR
3. CAPITOL HILL GATE

A. MASTER PLAN COMMERCIAL

- GAUR AERO SUITES
- GAURS RUNWAY SUITES
- THE HUB
- PETROL PUMP
- MULTI LEVEL CAR PARKING
- COMMERCIAL FOOT PRINT / AEROCITY

B. SCHOOL / INSTITUTIONAL

- EDUCATIONAL PLOTS

C. CONVENIENT / SECTOR SHOPPING

D. DISPENSARY

- NURSING HOME (NH)

E. GYC GALLERIA

GR-01. ECO PARK

- LAKE YAMUNA
- CHILDREN'S PARK
- PICNIC SPOT
- BOATING FACILITIES
- FOOD COURT
- LAKE PROMENADE & BIRD WATCHING

GR-02. CULTURAL CITY CENTER (SPORTS PARK)

- OPEN AIR THEATER
- CHILDREN'S PLAY AREA
- CRICKET GROUND
- OTHER SPORTS FACILITIES

FACILITIES

- RELIGIOUS PLOT
- MILK BOOTH
- CLUB FACILITIES

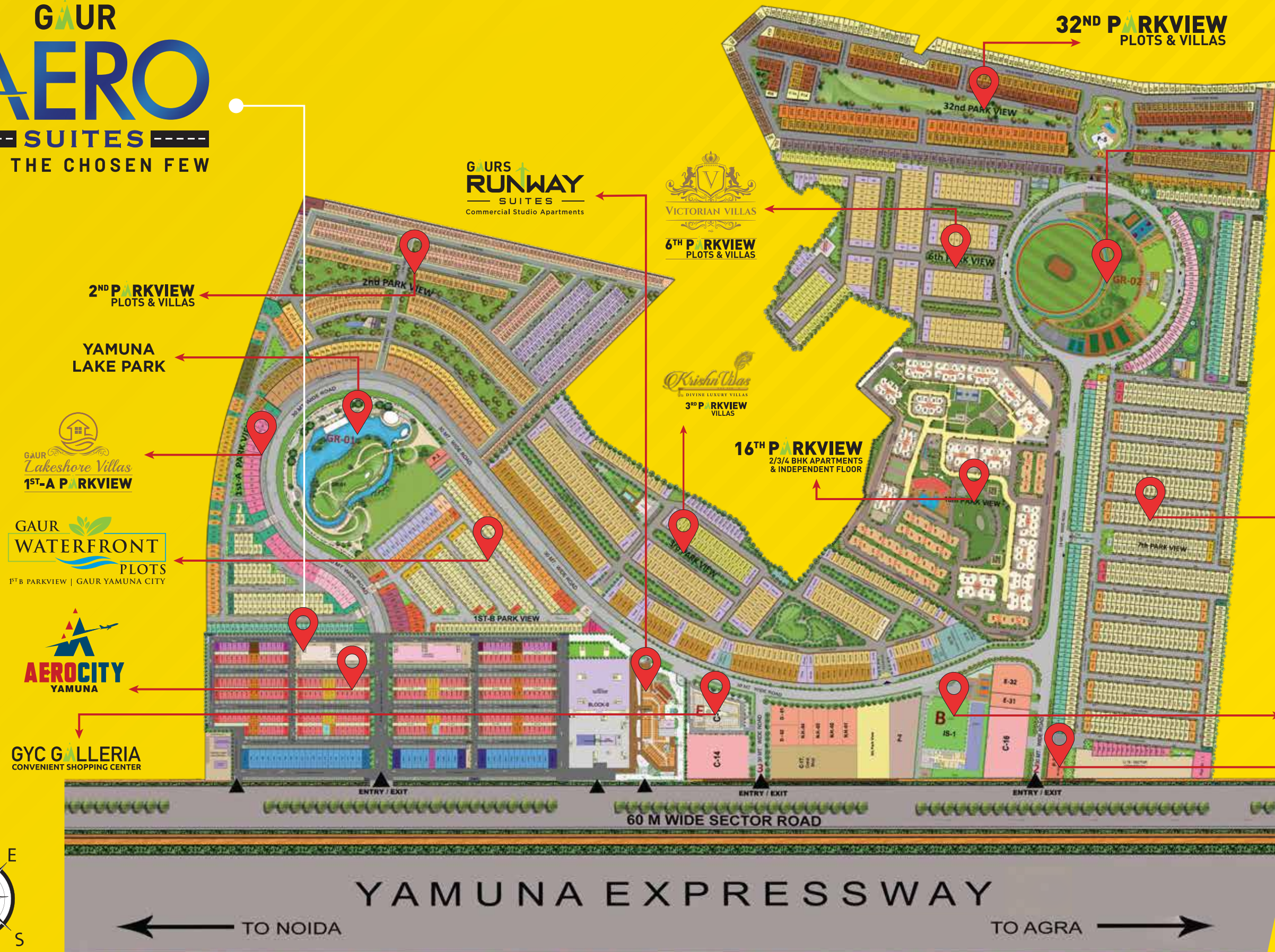
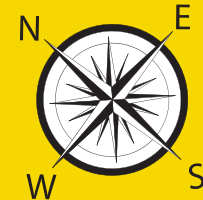

BHAGWAN SHRI KRISHNA MURTI & SHRI RADHA KRISHNA MANDIR

Gaur Realty Pvt. Ltd. Sub Lease Deed of: Part 1 Vide Book No-1, Vol No-13251, Page No-289 to 450, Registration / Document No-17798, Sub Registrar Sadar, Gautambudh Nagar, (U.P.) on 05-10-2013, Part 3 Vide Book No-1, Vol No-14828, Page No-227 to 282, Registration / Document No-781, Sub Registrar Sadar, Gautambudh Nagar, (U.P.) on 09-01-2014, Part 4 Vide Book No-1B236, Page No-188 to 242, Registration / Document No-20325, Sub Registrar Sadar, Gautambudh Nagar, (U.P.) on 27-06-2014, Part 5 Vide Book No-1 Vol No-18526, Page No-107 to 162, Registration / Document No-25183, Sub Registrar Sadar, Gautambudh Nagar, (U.P.) on 31-07-2014, Project Approval No. 6th ParkView, PLG/16/28/40072/2017 dated 15-11-2017, 2nd & 32nd ParkView, Letter No-YEA/PLG/16/28/40072/2017 dated 31-03-2017, 3rd & 6th ParkView, Letter No-YEA/PLG/16/28/40072/2017 dated 10-04-2018, Gaur Runway Suites, Letter No-YEA/PLG/16/28/40072/2017 dated 07-02-2018, 7th ParkView, Letter No-YEA/PLG/16/28/40072/2017 dated 14/10/2020 by Yamuna Expressway Industrial Development Authority, Map sanctioned by Yamuna Expressway Industrial Development Authority, All images, perspective, specifications, features, figures, are only indicative and not a legal offering. All project related sanctions any other statutory compliance can be seen in person at our office. 1 sq. mtr. = 10,764 sq. ft., 1 acre = 4047 sq. mtr. (approx.) 1 sq. yd. = 0.84 sq. mtr. (approx.)

SITE PLAN

1ST-A PARKVIEW

1ST-B PARKVIEW



LEGEND FOR PHASE - 1 :- PLOT 'S

TYPE - A		TYPE - B		TYPE - C	
<p>TYPE A1</p> <p>PLOT SIZE :- 10.07 X 25M AREA = 251.75 SQM. = 301.09 SOYD.</p>	<p>02</p> <p>TYPE A2</p> <p>PLOT SIZE :- 10.79 X 25M AREA = 269.75 SQM. = 322.62 SOYD.</p>	<p>04</p> <p>TYPE B1</p> <p>PLOT SIZE :- 6.88 M X 12M AREA = 82.32 SQM. = 98.45 SOYD.</p>	<p>18</p> <p>TYPE B5</p> <p>PLOT SIZE :- 6.54 M X 12M AREA = 78.48 SQM. = 93.86 SOYD.</p>	<p>02</p> <p>TYPE C1</p> <p>PLOT SIZE :- 6.50 M X 14.25M AREA = 92.63 SQM. = 110.78 SOYD.</p>	<p>22</p> <p>TYPE C3</p> <p>PLOT SIZE :- 8.25 M X 14.25M AREA = 117.56 SQM. = 140.60 SOYD.</p>
<p>TYPE A3</p> <p>PLOT SIZE :- 7.5 M X 25M AREA = 187.5 SQM. = 224.25 SOYD.</p>	<p>40</p> <p>TYPE A4</p> <p>PLOT SIZE :- 8.0 M X 25M AREA = 200 SQM. = 239.20 SOYD.</p>	<p>193</p> <p>TYPE B3</p> <p>PLOT SIZE :- 6.5 M X 12M AREA = 78 SQM. = 93.29 SOYD.</p>	<p>01</p> <p>TYPE B4</p> <p>PLOT SIZE :- 6.88 M X 12M AREA = 82.32 SQM. = 98.45 SOYD.</p>	<p>23</p> <p>TYPE C2</p> <p>PLOT SIZE :- 6.50 M X 14.25M AREA = 92.63 SQM. = 110.78 SOYD.</p>	<p>04</p> <p>TYPE C4</p> <p>PLOT SIZE :- 10.0 M X 14.25M AREA = 142.5 SQM. = 170.43 SOYD.</p>
<p>TYPE - A, TOTAL PLOTS :- 47</p>		<p>TYPE - B, TOTAL PLOTS :- 256</p>		<p>TYPE - C, TOTAL PLOTS :- 40</p>	
<p>TOTAL NOS. OF ALL SIZE'S FOOT PRINT BASIS PLOTS :- 343 nos.</p>					

Plot Size, Entry and location - As per GYC site plan sanctioned with dimension. Plot Entry marked and plot area detail. Plot set back as per YEIDA Authority norms.

Gaurs Realtech Pvt. Ltd. Sub Lease Deed of: Part 1 Vide Book No-1, Voll No-13251, Page No-289 to 450, Registration / Document No-11798, Sub Registrar Sadar, Gautambudh Nagar, (U.P.) on 22-05-2013. Part 2 Vide Book No-1, Voll No-14222, Page No-85 to 134, Registration / Document No-24479, Sub Registrar Sadar, Gautambudh Nagar, (U.P.) on 05-10-2013. Part 3 Vide Book No-1, Voll No-14828, Page No-227 to 282, Registration / Document No-781, Sub Registrar Sadar, Gautambudh Nagar, (U.P.) on 09-01-2014. Part 4 Vide Book No-18236, Page No-189 to 242, Registration / Document No.-20325, Sub Registrar Sadar, Gautambudh Nagar, (U.P.) on 27.06.2014. Part 5 Vide Book No-1 Voll No- 16526, Page No-107 to 182, Registration / Document No-25183, Sub Registrar Sadar, Gautambudh Nagar, (U.P.) on 31-07-2014. Project Approval No. 8th Parkview: PLG/(BP)-29/40072/2017/27 Dated 15-11-2017. 2nd 8.32nd Parkview: Letter No-YEA/PLG/(BP)-62/19003/2016 Dated 31-03-2017. 3rd & 6th Parkview: Letter No-YEA/PLG/(BP)-62/54470 Dated 10-04-2018. Gaurs Runway Suites: Letter No-YEA/PLG/(BP)-96/79424, Dated 07-02-2019. 7th Parkview: Letter No-YEIDA/PLG/BP-62/901/2020 Dated: 14/10/2020 by Yamuna Expressway Industrial Development Authority. Map sanctioned of Gaurs Yamuna City Township Project, vide letter Ref. No. Y.E.A/PLANNING/BP-62/19003/2016 Dated: 31/03/2017 by Yamuna Expressway Industrial Development Authority.

All images, perspective, specifications, features, figures, are only indicative and not a legal offering. All project related sanctions any other statutory compliance can be seen in person at our office. 1 sq. mtr.= 10.764 sq. ft. 1 acre=4047 sq. mtr. (approx.) 1 sq. yd. = 0.84 sq. mtr. (approx.)



GROUND FLOOR PLAN

1ST - A PARKVIEW



NIA
HIGH STREET

@

GOUR
AERO
SUITES
FOR THE CHOSEN FEW



1ST TO 14TH TYPICAL FLOOR PLAN

1ST - A PARKVIEW



- - Y A M U N A E X P R E S S W A Y S I D E - -



15TH FLOOR PLAN

1ST - A PARKVIEW

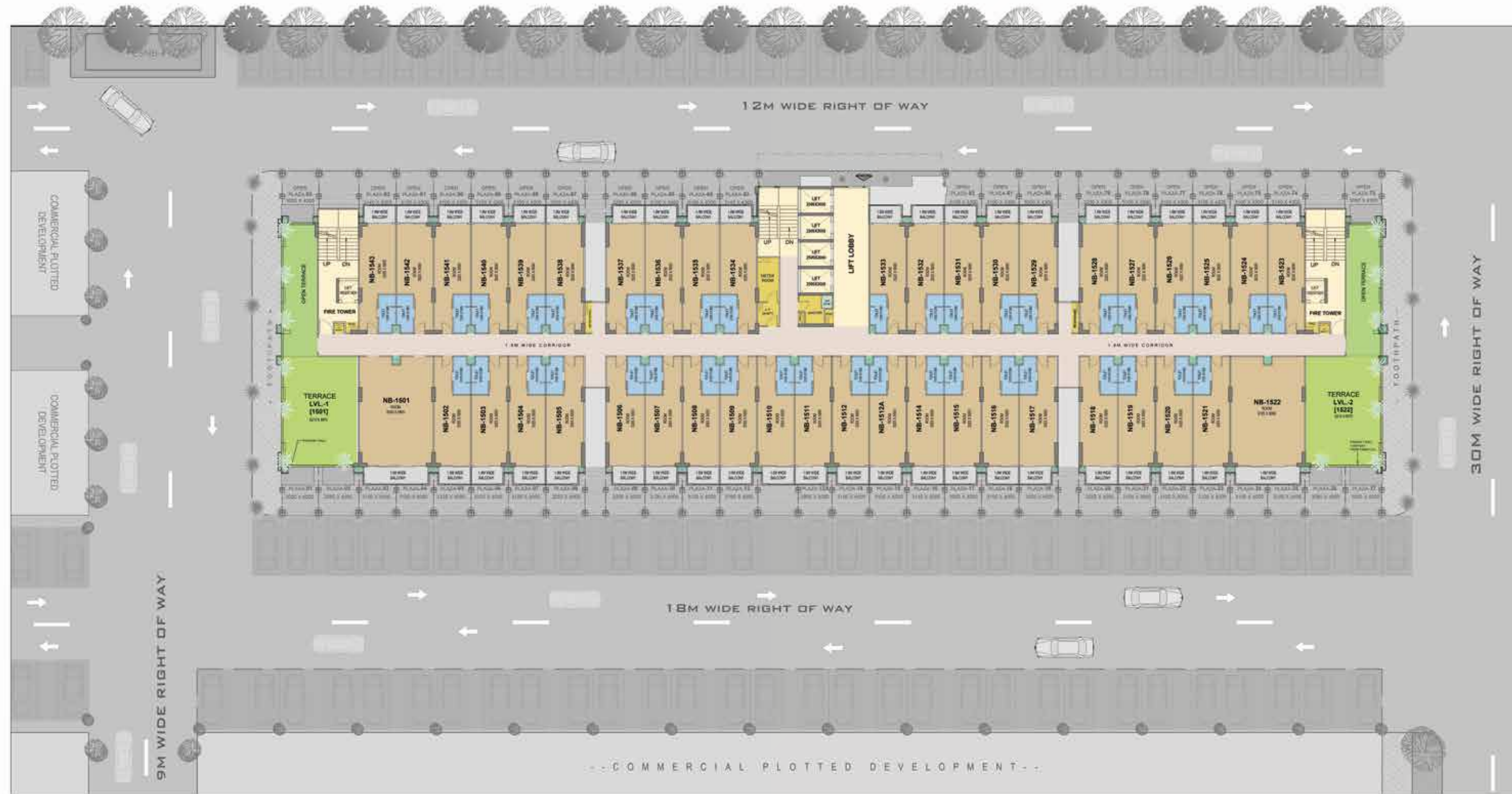

-- YAMUNA EXPRESS WAY SIDE --



16TH FLOOR PLAN

1ST - A PARKVIEW

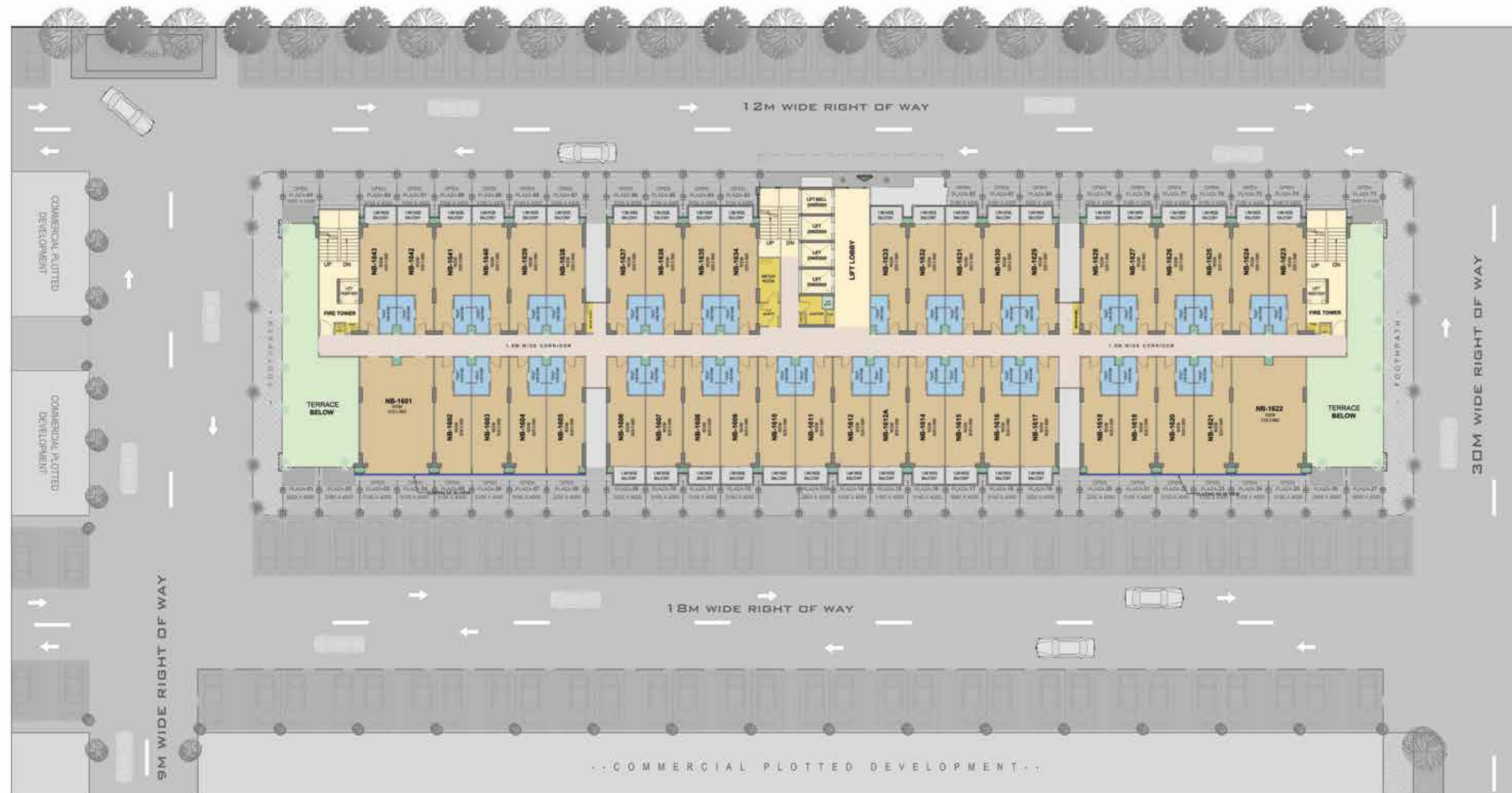

YAMUNA EXPRESS WAY SIDE



UNIT PLAN

ONE (1) BEDROOM

TOTAL SALEABLE AREA
45.06 SQ. MTR. (485 SQ. FT.)



CARPET AREA	26.65 Sq.mtr. (286.86 Sq.ft)
COVERED AREA	28.28 Sq.mtr. (304.41 Sq.ft)
BALCONY AREA	4.12 Sq.mtr. (44.35 Sq.ft)
COMMON AREA (FLOOR)	7.64 Sq. mtr. (82.23 Sq.ft)
TOTAL SALEABLE AREA	45.06 Sq. mtr. (485.0 Sq.ft.)

Disclaimer:

Total Area: The total area including of other constructed areas including the constructed common areas over the carpet area which is duly mentioned in the lay out plan of the unit.
Carpet Area: The Carpet area means the net usable floor area of a unit, excluding the area covered by the external walls, areas under services shafts, exclusive balcony or verandah area and exclusive open terrace area, but includes the area covered by the internal partition walls of the apartment.
1 Sqm=10.764 sq. ft., 304.8mm=1'-0".

All Specification, designs, layout, images, conditions are only indicative and some of these can be changed at the discretion of the builder, these are purely conceptual and constitute no legal offerings. •The colour and design of the tiles can be changed without any prior notice. • Variation in the colour and size of vitrified tiles/granite may occur. • Variation in colour in mica may occur. • Area in all categories of apartments may vary up to ±3% without any change in cost. • However, in case the variation is beyond ±3% charges are applicable.

PROJECT SPECIFICATIONS

DETAILS

TOTAL NO. OF SUITES	: 800 UNITS
TOTAL NO. OF SHOPS	: 93 SHOPS
NO. OF FLOORS	: Basement level (Services), : Ground floor (Shopping Floor, Restaurants, Suites Reception, Lobby Area etc.) : Service floor (For services). : 1 st - 12 th - 12 th A, 14 th Floor (Suites). : 15 th Floor (Suites & open terrace). : 16 th Floor (Suites) : 17 th Floor [Multipurpose Hall & Terrace]

NO. OF SHOPS & SUITES PER FLOOR

GROUND FLOOR	: 93 Shops
SERVICE FLOOR	: Service floor
1 st FLOOR-12 th -12 th A-14 th (TOTAL NO. OF FLOOR = 14)	: 51 Suites each Floor (1402-1429 & 1432-1454)
15 th FLOOR	: 43 Suites (1501-1543) & open terrace.
16 th FLOOR	: 43 Suites (1601-1643)
17 th FLOOR	: Hall with Amenities & Terrace

VITAL PROJECT RELATED INFORMATION

AIR CONDITIONING	: Split AC installation space only for Shops [As its own Requirement] [To be installed by owner] -Window AC will be not allowed in Retail Area, -Split AC in Suites with outdoor unit in balcony. [To be installed by owner]
FLOOR TO FLOOR HEIGHT	: 6300 mm Height for Shops [Ground floor to First floor]. -3750 mm Height for Shops [Ground floor to Service floor]. -2550 mm Height (Floor to Floor) for services (Service floor). -3150 mm Height (Floor to Floor) for Suites.

LIFTS

LIFTS	: 2 No. Lifts for Fire Tower (for suites/Hall).
LIFTS	: 4 No. Passenger Lift for Suite/Hall.
SPECIFICATION OF LIFTS	: SS Finish from Inside and Outside with M.S. door on Landings. SS door on Entrance lobby.

LOBBY AND COMMON AREAS

FLOORING	: Granite Flooring / Vitrified Tile Flooring
CEILING	: Exposed RCC with exposed services running below RCC.

PAINTING	: OBD Paints and Exposed Services
RAILING	: M.S Railing as per design.
WALLS	: Plastered Walls with Paint.
ELECTRICITY	: Common Area and Corridor Lighting
FIRE FIGHTING	: As Per Fire NOC
STAIRCASE	: Tile Flooring
LIGHTING	: Tube Light / Ceiling Mounted LED Light Fixture

BASEMENT AREA

SERVICES	: Trimix Concrete Flooring.
LIGHTING	: Tube Light / Ceiling Mounted LED Light Fixture.
RAMP	: Trimix Concrete Flooring.
FIRE FIGHTING	: As Per Norms.

LANDSCAPING

HARD LANDSCAPE	: Tiles / Trimix Concrete / Pavers / Kerb Stone / Chequered Tiles
SOFT LANDSCAPE	: Natural Grass / Artificial Grass Pad / Shrubs / Plants / Trees.
LIGHTING	: As Per Design

ESS AND DG (MAX. CAPACITY)

DG SET	: As per Load Requirement for Essential Services.
TRANSFORMER	: As Per Load Requirement Single-point Electrical Connection from NPCL/UPPCL

COMMON TOILET

Male, Female Toilet on Ground floor	
FLOORING	: Antiskid Tile Flooring
PAINTING	: OBD Paints and Exposed Services.
WALL CLADDING	: Tile Dado up to 2100 mm ht.
WC	: European WC
CP FITTING	: Chrome Plated
URINALS	: As Per Selection
WASH BASIN	: As Per Selection

SHOPS

FLOORING	: RCC Slab- Ready to receive any Flooring by Owner / Buyer.
WALLS shops	: 75 mm thick Dry Wall Partition (Between CEILING : Exposed RCC Ceiling (No Finishing) DOORS : M.S Rolling Shutters on opening the Shop front.
fixed inside of	ELECTRICITY : One DB as per required Load Single point/multi point connection from NPCL/UPPCL
will be Provided.	FIRE FIGHTING : As Per Fire NOC

PROJECT AMENITIES

FLOORING

Vitrified tiles (130x800 mm) Flooring.
Make-SARA, SOLE, SPEL, KAJARIA OR EQUIVALENT.

Ceramic tiles (300x600mm) in balcony area . Make-SARA, SOLE, SPEL, ANMAL RANGE, KAJARIA OR EQUIVALENT.

WALL & CEILING FINISH

POP Finished Wall with OBD

Ceiling with OBD. Make-BERGER, NEROLAC, SHALIMAR.

PANTRY

Dry Pantry Platform with Sink on Granite Counter Top, Make-PANTHER, LOTUS OR EQUIVALENT.

600 mm DADO above the Working Top only with Granite.

Woodwork Below the Working Top (non modular type)

TOILET

Ceramic Tiles (400x800 mm) on Floor.
Make-SARA, SOLE, SPEL, ANMAL RANGE, KAJARIA OR EQUIVALENT.

Ceramic Tiles (400x800mm) on Wall upto Door Height.

White sanitary ware with wall mounted E.W.C
Make-HINDWARE, PARRYWARE, JOHNSON OR EQUIVALENT.

C.P Fittings Make-BLISS, PANTHER, JAGUAR OR EQUIVALENT.

DOORS & WINDOWS

Outer Door and Windows Aluminium Powder Coated/UPVC.

Internal Door Frame (2250 mm) Made of Marandi or Equivalent Wood with Laminated Door Shutter Make-DURIAN, RAMA PLY OR EQUIVALENT.

Main Entry Door Frame (2250mm) Made of Marandi or Equivalent Wood with Laminated Door Shutter Make-DURIAN RAMA PLY OR EQUIVALENT.

Good Quality Hardware Fittings.

ELECTRICAL

Copper Wire in PVC Conduit with MCB Supported Circuits and Adequate Power and Light Points in Wall and Ceiling.
MCB Make - LEGRAND, L&T, HAVELLS OR EQUIVALENT.
Copper Wire Make - TYCON, HI AGE, CORUS OR EQUIVALENT.
Switch & Sockets Make - ANCHOR, HONEYWELL OR EQUIVALENT.

TELEPHONE POINT

Intercom with Telephone Instrument.

BASEMENT AREA

SERVICES	: Trimix Concrete Flooring.
LIGHTING	: Tube Light / Ceiling Mounted LED Light Fixture.
FIRE FIGHTING	: As Per Norms.

LANDSCAPING

HARD LANDSCAPE	: Tiles / Trimix Concrete / Pavers / Kerb Stone / Chequered Tiles.
SOFT LANDSCAPE	: Natural Grass / Artificial Grass Pad / Shrubs / Plants / Trees.
LIGHTING	: As Per Design

ESS AND DG (MAX. CAPACITY)

DG SET	: As per Load Requirement for Essential Services.
TRANSFORMER	: As Per Load Requirement : Single-point/multi-point Electrical Connection from NPCL/UPPCL

STP

CAPACITY (IN BASEMENT) : As Per Requirement

NOTES

- The colour and design of tiles can be changed without any prior notice.
- Variation in the colour and size of the vitrified tiles/granite may occur.
- Variation in colour in mica can occur.
- Area in all categories of apartments can vary upto +- 3% without any change in cost.
- However, in case the variation is beyond +- 3%, pro rata charges are applicable.





GAURS INTERNATIONAL SCHOOL

तमसो मा ज्योतिर्गमय।
@

GAUR YAMUNA CITY, YAMUNA EXPRESSWAY

THE RIVER OF KNOWLEDGE FLOWS AGAIN OPERATIONAL 3RD SCHOOL AT YAMUNA EXPRESSWAY

After the success of two branches of Gaur International School at Gaur City with 4000+ students, we bring the premier educational institute to Gaur Yamuna City. Equipped with world-class facilities amidst top notch infrastructure and an international curriculum, Gaur International School believes in nurturing your child in every aspect.

GIS HIGHLIGHTS

- AC Classrooms
- Best Teacher Student Ratio
- Smart Classrooms With Projectors
- Amphitheatre
- Music, Art & Dance Room
- Medical Room
- RFID Enabled ID Cards
- CBSE Based Curriculum
- Cricket Pitch
- Football
- Volley Ball
- GPS Enabled Buses*

*Procuring soon



ARTIST'S IMPRESSION



Artist's Impression

Jai Shri Krishna



YAMUNA EXPRESSWAY

is blessed with India's tallest statue of Lord Shri Krishna standing majestically at 108 feet height atop a grand Temple (Under development)

Scan for video



Actual Image

ADMISSIONS NOW OPEN FOR SESSION 2023-2024

NURSERY TO 8TH STANDARD

www.gaurinternationalschool.com

Disclaimer:

All images including stock images, colours, pictures and accessories are indicative and used for illustrative purposes only. For the actual project details, please refer to the specifications mentioned in the subsequent pages of this brochure.

SUCCESS FOUNDED ON TRUST



Trust is the building block of our success

Ever since its inception in the year 1995, Gaurs has been revered as an icon of excellence in the world of real estate. With a burgeoning list of residential projects that encompass high end apartments to highly affordable accommodations occupied by thousands of happy families, Gaurs' stress on customer's trust has become the winning mantra.

The pointed relentless focus on creating a better tomorrow has been the driving force at Gaurs. It is our foresight, eye for perfect locations and excellence in execution that has earned us much-deserved success throughout our long journey. And armed with the confidence and verve to enrich lives, one can safely say that the future belongs to Gaurs.



SMART CITY EMPOWERING INDIA AWARDS 2020
BEST SMART CITY DEVELOPER OF THE YEAR
- GAURSONS INDIA



CNBC AWAAZ REAL ESTATE AWARDS 2018-19
BEST RESIDENTIAL PROJECT AFFORDABLE SEGMENT - NORTH ZONE
- GAUR CITY-2



PMAY EMPOWERING INDIA AWARDS 2019
THE MOST WELL PLANNED UPCOMING PROJECT IN EWS CATEGORY
- GAURS SIDDHARTHAM



TIMES BUSINESS AWARDS 2019
BEST REAL ESTATE DEVELOPER OF THE YEAR
- GAURSONS INDIA



CNBC AWAAZ REAL ESTATE AWARDS 2017-18
BEST RESIDENTIAL PROJECT AFFORDABLE SEGMENT - NATIONAL
- GAUR CASCADES



CNBC AWAAZ REAL ESTATE AWARDS 2017-18
BEST RESIDENTIAL PROJECT AFFORDABLE SEGMENT - NORTH INDIA
- GAUR CASCADES



NDTV PROPERTY AWARDS 2016-17
BUDGET APARTMENT PROJECT OF THE YEAR (2017) TIER 1 CITIES
- GAUR CASCADES



NDTV PROPERTY AWARDS 2016-17
BEST TOWNSHIP PROJECT
- GAUR CITY



CNBC AWAAZ REAL ESTATE AWARDS 2016-17
BEST TOWNSHIP PROJECT
- GAUR CITY

THE HALLMARKS TO OUR CREDIT

ONGOING RERA REGISTERED PROJECTS

Gaur Mulberry Mansions, Gr. Noida (West)
UPRERAPRJ7057, UPRERAPRJ4897

KrishnVilas (3rd Parkview) Gaur Yamuna City
UPRERAPRJ16103

Gaurs Siddhartham, Siddharth Vihar UPRERAPRJ3935

Victorian Villas (6th Parkview) Gaur Yamuna City
UPRERAPRJ15838

16th Parkview Phase-II, Gaur Yamuna City
UPRERAPRJ6801

7th Parkview, Gaur Yamuna City UPRERAPRJ16087

7th Avenue, Phase-II, Gaur City, Gr. Noida (West)
UPRERAPRJ6695

14th Avenue Phase-II, Gaur City-2, Gr. Noida (West)
UPRERAPRJ6742

Gaur City Mall, Office Spaces, Gr. Noida (West)
UPRERAPRJ6934

Gaurs Runway Suites, Gaur Yamuna City
UPRERAPRJ351477

Gaur City Center Ph-II, Gr. Noida West
UPRERAPRJ4780

Gaur World SmartStreet,
(Formerly known as Gaur World Street)
Gr. Noida (W) UPRERAPRJ674297

Gaur Lakeshore Villas (1st-A Parkview)
Gaur Yamuna City UPRERAPRJ574384

Gaur Waterfront Plots (1st-B Parkview)
Gaur Yamuna City UPRERAPRJ235739

Aerocity Yamuna, Gaur Yamuna City
UPRERAPRJ342117

The Islands by Gaurs, Gr. Noida
UPRERAPRJ734569



DELIVERED COMMERCIAL PROJECTS

Gaur Plaza, Shalimar Garden, Ghaziabad
Gaur Residency-Gravity, Chander Nagar, Ghaziabad
Gaur Galaxy-Gravity, Vaishali, Ghaziabad
Gaur Square Govindpuram, Ghaziabad
Gaur Green City-Gravity, Indirapuram, Ghaziabad
Gaur Homes-Gravity, Govindpuram, Ghaziabad
Gaur Heights-Gravity, Vaishali, Ghaziabad
Gaur Ganga-Gravity, Vaishali, Ghaziabad
Gaur Ganga-I-Gravity, Vaishali, Ghaziabad
Gaur Ganga-II-Gravity, Vaishali, Ghaziabad

Gaur Green Vista-Gravity, Indirapuram, Ghaziabad
Gaur Gracious-Gravity, Moradabad
Gaur Global Village-Gravity, NH-24, Ghaziabad
Gaur Grandeur-Gravity, Sector-119, Noida
Gaur Valerio-Gravity, Indirapuram, Ghaziabad
Gaur Cascades-HI-Street, NH-58, Raj Nagar Extn.
Gaur Central Mall, Rajnagar, Ghaziabad
Gaur High Street (Rajnagar Extn.), Ghaziabad
Gaur Biz Park, Indirapuram, Ghaziabad
Gaur Gravity, Ghaziabad

Gaur City Plaza, Greater Noida West
Gaur City Galleria, Greater Noida West
Gaur City Arcade, Greater Noida West
GYC Galleria, Gaur Yamuna City, Yamuna Expressway
Gaur Atulyam-Gravity, Gr. Noida
Gaur Saundaryam High-Street, Gr. Noida (W)
Gaurs Sportwood Arcade, Sec-79, Noida
Gaur City Center Phase-I, Gr. Noida (W)
14th Avenue High Street, Gr. Noida (W)



DELIVERED RESIDENTIAL PROJECTS

Gaur Residency, Chander Nagar
Gaur Galaxy, Vaishali
Gaur Heights, Vaishali
Gaur Ganga, Vaishali
Gaur Ganga 1, Vaishali
Gaur Ganga 2, Vaishali
Gaur Green City, Indirapuram
Gaur Green Avenue, Indirapuram
Gaur Green Vista, Indirapuram
Gaur Valerio, Indirapuram
Gaur Homes, Govindpuram

Gaur Homes Elegante, Govindpuram
Gaur Grandeur, Noida
Gaur Global Village, Crossings Republik
Gaur Gracious, Moradabad
Gaur Cascades, Raj Nagar Extn. Ghaziabad
Gaur Saundaryam, Gr. Noida (West)
1st Avenue, Gaur City
4th Avenue, Gaur City
5th Avenue, Gaur City
6th Avenue, Gaur City
10th Avenue, Gaur City-2

11th Avenue, Gaur City-2
12th Avenue, Gaur City-2
16th Avenue, Gaur City-2
Gaur Sportwood, Sector-79, Noida
Gaur Atulyam, Gr. Noida
14th Avenue, Ph-1, Gaur City-2
7th Avenue, Ph-1, Gaur City
2nd Parkview, Gaur Yamuna City
16th Parkview Phase-1, Gaur Yamuna City
32nd Parkview, Gaur Yamuna City
Gaurs Platinum Towers, Sector-79, Noida



GAURS INTERNATIONAL SCHOOL

Gaur City-2, Greater Noida (West)
Junior Wing, Gaur City - 2, Greater Noida (West)
Gaur Yamuna City, Yamuna Expressway
Gaurs Siddhartham, Siddharth Vihar, Ghaziabad (Under Construction)



DELIVERED RETAIL PROJECTS

Gaur City Mall, Gaur Chowk, Greater Noida (W)
Gaur Central Mall, RDC, Raj Nagar, Ghaziabad



27+ YEARS OF UNFALTERING COMMITMENT | **65+** SUCCESSFULLY DELIVERED PROJECTS | **20000+** UNITS UNDER DEVELOPMENT | **40000+** POSSESSIONS GIVEN (2014-2021) | **65000+** DELIVERED UNITS | **100000+** HAPPY CUSTOMERS | **6000000+** SQUARE METER AREA DEVELOPED



FOR SALES ENQUIRY CALL:



SITE OFFICE:
SECTOR 19,
YAMUNA EXPRESSWAY,
DIST. GAUTAM BUDDH NAGAR (U.P.)

CORPORATE OFFICE:
GAUR BIZ PARK, PLOT NO-1,
ABHAY KHAND II, INDIRAPURAM
GHAZIABAD - 201014

GAUR AERO SUITES RERA REGN. NO.: **UPRERAPRJ342117** | www.up-rera.in

www.gaursonsindia.com

Member of



[www.facebook.com/
GaursonsIndiaPrivateLimited](https://www.facebook.com/GaursonsIndiaPrivateLimited)



[www.twitter.com/
gaursons_india](https://www.twitter.com/gaursons_india)



[@gaursonsindia](https://www.instagram.com/gaursonsindia)

LOAN AVAILABLE FROM:



CONSTRUCTION FINANCE PARTNER



AFTER SALES **CUSTOMER CARE 1800 180 3052**

REAL ESTATE | RETAIL | EDUCATION | HOTELS | NBFC | CONTRACTING | SPORTS | ENERGY